



ServiceLink National Flood  
1521 N Cooper Street, 4<sup>th</sup> Floor  
Arlington, TX 76011

800.833.6347, option 2  
grandfathered@bkfs.com  
www.servicelinknationalflood.com/insurance

---

## ***Grandfathered Flood Zone Determination\****

Customer Account #: 123456789  
Customer Name: ABC Insurance Agency

Date: 09/02/2008

---

### ***Property Information***

Policyholder Name: John R. Smith  
Reference/Policy #: R07890054  
Property Address: 11302 Brook Meadow Circle  
City: Houston State: TX Zip Code: 77089-5344

Date of Construction: 5/31/1979

Parcel #: 123-4456-7890

Legal Description: \_\_\_\_\_

---

### ***Historical Flood Hazard Information***

FEMA Community Name: Houston, City of

County: Harris

FEMA Map Number: 480287-0525C

Map Effective Date: 02-24-1981

Flood Zone: C

BFE/Depth: N/A

CBRA Date (if applicable): N/A

LOMC Date (if applicable): N/A

Additional Notes: \_\_\_\_\_

**Please refer to the pages following this form for exhibits of the above-referenced historical FEMA Flood Insurance Rate Map.**

---

\*DISCLAIMER: This Grandfathered Determination represents historical data only per out-of-date FEMA Flood Insurance Rate Maps [FIRMs]. This product is for reference purposes only and is not to be construed or used as a legal document or survey instrument. ServiceLink National Flood assumes no responsibility for any use of the information contained herein or loss resulting there from, and any reliance on this information is at the user's own risk. This information should not be relied on for decisions related to purchasing or developing land.

Copyright ServiceLink National Flood. All Rights Reserved.

## Historic Flood Insurance Rate Map Exhibit

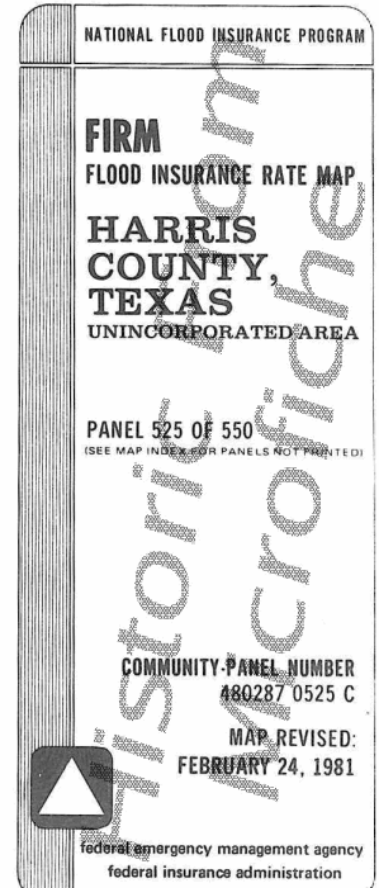
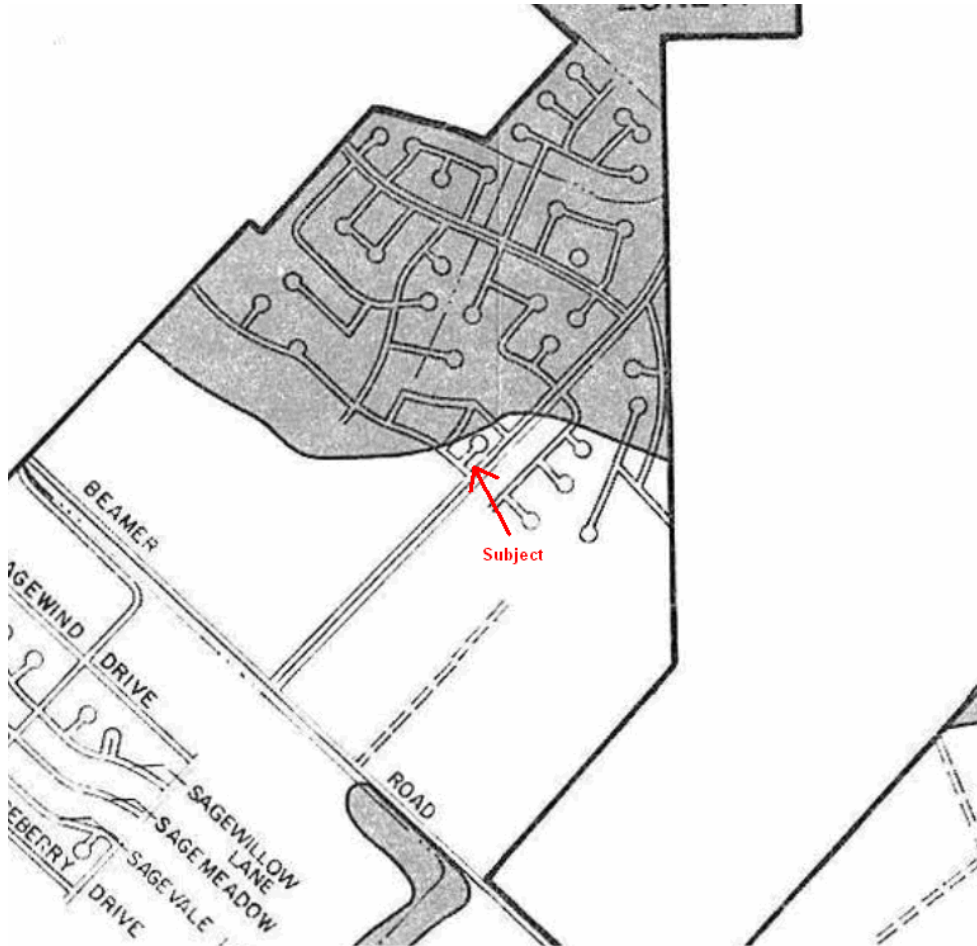

\*DISCLAIMER: This Grandfathered Determination represents historical data only per out-of-date FEMA Flood Insurance Rate Maps [FIRMs]. This product is for reference purposes only and is not to be construed or used as a legal document or survey instrument. ServiceLink National Flood assumes no responsibility for any use of the information contained herein or loss resulting there from, and any reliance on this information is at the user's own risk. This information should not be relied on for decisions related to purchasing or developing land.

Copyright ServiceLink National Flood. All Rights Reserved.